

NOTES:

- 1 Mounting height to top of steel beam rail measured vertically at face of rail.
 - 2 Slope shall be flatter when specified.
 - 3 Type M SBGR includes Type M20 and Type M30. The minimum length of Type M SBGR to be installed upstream and downstream of the long span treatment shall be 19.05m.
 - 4 Obstacles shall not protrude more than 50mm above the finished grade.
 - 5 Four (7/8") diameter A193 B7 Super HAS all threaded anchor rods (216mm, 8 1/2" long) with washer and nut installed with Hilti RE500 V3 epoxy. Holes for anchors shall be 25mm (1") diameter diamond core drilled.
- A For precast culverts with distribution slab according to OPSD 3920.110, threaded rods shall be embedded 150mm into top of precast box culvert.
- B For precast culverts with distribution slab according to OPSD 3920.110, waterproofing shall not be installed under or within 50mm of base plates.
- C System configuration meets AASHTO MASH TL-3.
- D All dimensions are in millimetres unless otherwise shown.

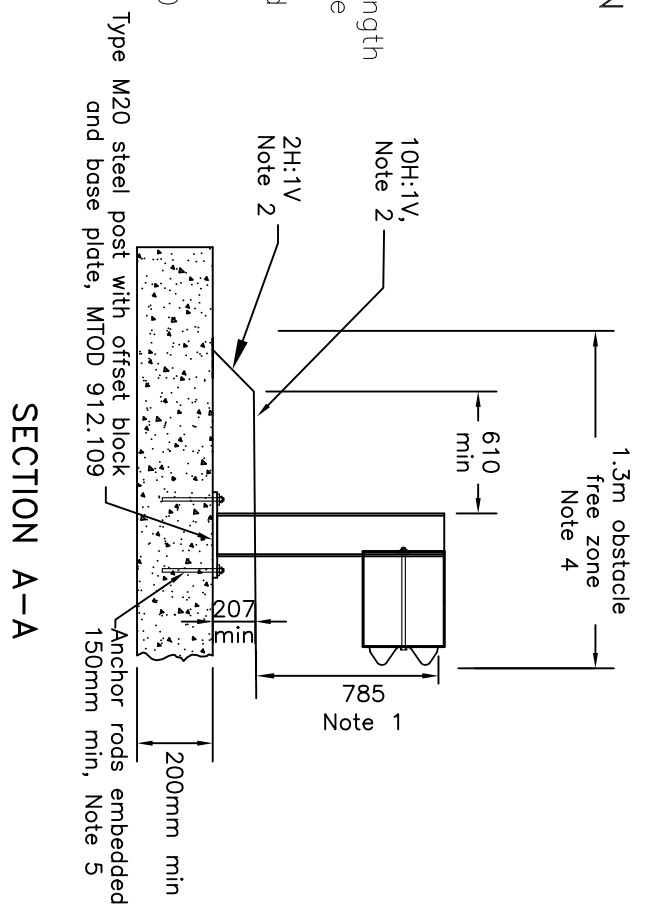

MINISTRY OF TRANSPORTATION ONTARIO DRAWING	April 2016	Rev 0
GUIDE RAIL SYSTEM, STEEL BEAM		
TYPE M -- BASE PLATED FOR SHALLOW		
BOX CULVERTS INSTALLATION		
MTOD -- 912.249		